



507 N. Nanum Street, Suite 102  
 Ellensburg, WA 98925  
 T: 509.962.7515 F: 509.962.7581  
 www.co.kittitas.wa.us/health

**FOR OFFICIAL USE ONLY:**  
 Accepted By: KS  
 Tracking #: SF-20-00011  
 Date Processed: 12-2-2020  
 Receipt #: PH20-01382

## Soil Log Evaluation for Land Subdivision

**\$430.00 Soil Log Evaluation fee is non-refundable after service has been provided.**

Call or go online to <https://www.co.kittitas.wa.us/health/services/liquid-waste.aspx> to schedule your inspection

Owner Name: Zipperer Tax Parcel #: 15148  
 Site Address: 311 Big Creek Road Acreage Size: 29.56  
 City, State, Zip: Cle Elum, WA 98922 Owner/Agent Signature: [Signature]  
 Plat Name: Earl Gentry SP- (Zipperer Short Plat Pending) E-mail: justinzipperer@yahoo.com

Soil Log # <u>142</u> Lot# <u>2</u>		Texture	Structure	Color
Depth	Feet			
1-		S.C.L	* medium * coarse sands	Dark Brown
-				
2-				
-				
3-				
-				
4-				
-				
5-				
-				
6-				

Soil Log # <u>384</u> Lot # <u>1</u>		Texture	Structure	Color
Depth	Feet			
1-		S.C.L	* coarse sands * High % cobbles	Brown
-				
2-				
-				
3-				
-				
4-				
-				
5-				
-				
6-				

Soil Log # <u>485</u> Lot # <u>1</u>		Texture	Structure	Color
Depth	Feet			
1-		S.C.L	* Gravel root growth * large co * High % sand at base	
-				
2-				
-				
3-				
-				
4-				
-				
5-				
-				
6-				

Soil Log # <u>887</u> Lot #		Texture	Structure	Color
Depth	Feet			
1-		L.S	* High % sand & cobble * gravel root growth	
-				
2-				
-				
3-				
-				
4-				
-				
5-				
-				
6-				

EH Inspector's Signature: \_\_\_\_\_ Date: \_\_\_\_\_









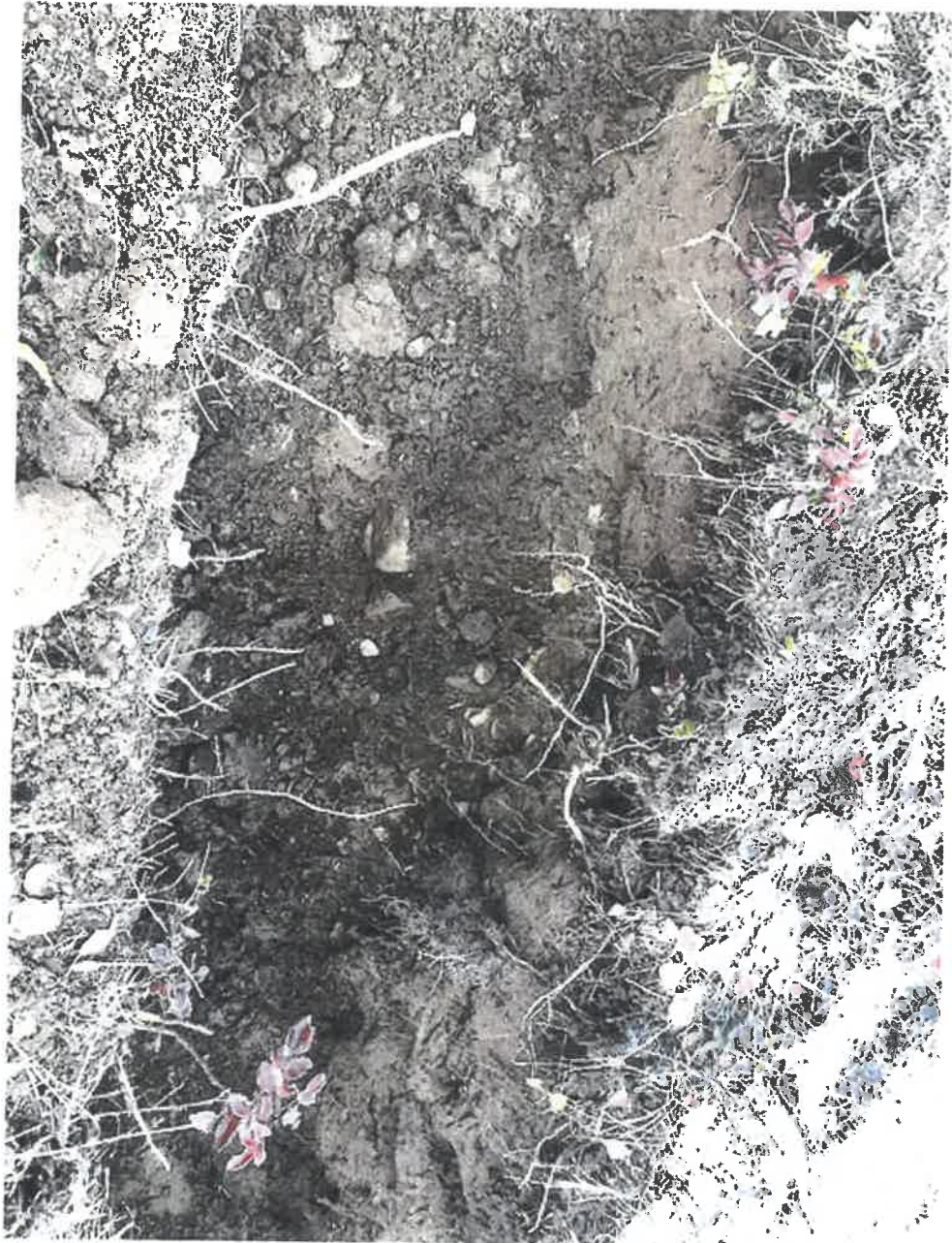











KITTITAS COUNTY  
PUBLIC HEALTH

Receipt Number: PH20-01382

507 N Nanum St., Suite 102  
Ellensburg, WA 98926  
509-962-7515 / <https://www.co.kittitas.wa.us/health/>

**Payer/Payee:** SIX ZIP REALTY INC, JUSTIN AND  
STEPHANIE ZIPPERER  
PO BOX 971  
CLE ELUM WA 98922-0971

**Cashier:** KIM SHILLEY  
**Payment Type:** CHECK (348)

**Date:** 12/02/2020

SE-20-00011      Soil Log for Short Plat      311 BIG CREEK RD, CLE ELUM 98922

<u>Fee Description</u>	<u>Fee Amount</u>	<u>Amount Paid</u>	<u>Fee Balance</u>
SOIL LOG FOR SHORT PLAT APPLICATION	\$430.00	\$430.00	\$0.00
<b>SE-20-00011 TOTALS:</b>	<b>\$430.00</b>	<b>\$430.00</b>	<b>\$0.00</b>
<b>TOTAL PAID:</b>		<b>\$430.00</b>	



507 N. Nanum Street, Suite 102  
 Ellensburg, WA 98926  
 T: 509.962.7515 F: 509.962.7581  
 www.co.kittitas.wa.us/health/

FOR OFFICIAL USE ONLY	
Accepted By:	
Permit #:	
Date Processed:	
Receipt #:	

**INSTALLATION PERMIT APPLICATION**

A "Permit to Install a Sewage System" allows the Landowner to install or to contract a licensed OSS installer to install an on-site septic system according to the design approved by the Health Officer. Development other than that described on the permit application and approved design, may without advanced approval of the Health Officer invalidate the Permit. **A sewage system installation permit expires one year from the month of issuance. A one year renewal permit may be applied for prior to expiration.**

**REQUESTED BY:**

Parcel Owner: **JUSTIN & STEPH ZIPPERER**  
 Site Address: **311 BIG CREEK ROAD**  
**311 BIG CREEK ROAD**  
 Mailing Address:

Telephone: **509-304-9062-MARK**  
 E-Mail: **MCN.ELLENSBURG@GMAIL.COM**  
 Requested By: **MARK NELSON**

**SITE INFORMATION:**

Assessor's Parcel Number: **15148**  
 Parcel Size: **29.56 ACRES**  
 Directions to site:

Subdivision: **EARL GENTRY SP**  
 Block:  
 Lot: **1**

**STRUCTURE (check all that apply):**

- Proposed OR  Existing  
 On-site construction OR  Manufactured  
 Single OR  Multiple family dwelling  
 Other:

Number of bedrooms (per dwelling unit): **3**  
 Number of (intended) permanent occupants: **6**

**DRINKING WATER SUPPLY:**

- Public Group A  
 Name of system:  
 Public Group B  
 Name of system:  
 Private well  
 Shared well  
 Cistern

**Fee Information (fees are non-refundable)**

**PERMIT APPLIED FOR:**

- New  
 Repair  
 Alteration  
 Redesign  
 Tank Placement

**TYPE OF SYSTEM:**

- Conventional/Gravity (\$555.00)  
 Homeowner Gravity Design (\$2,210.00)  
 Pressure (\$735.00)  
 Alternative (\$800.00)  
 Commercial (\$1,045.00)

**PREFERRED NOTIFICATION METHOD:**

- Pick up (Public Health front desk)  
 Mail  
 E-Mail  
 No copy requested at this time

**SEPTIC TANK:**

(Must be from State approved list)

- New  
 Existing  
 Gallons: **1000**

**PUMP CHAMBER**

- New  
 Existing  
 Gallons:

**DRAIN FIELD CALCULATIONS**

Gallons per day: **360** GPD  
 Application Rate: **4** Gals/Sq.Ft/Day  
 Reduction Factor: **40** %  
 Drain Field Area: **540** Sq. Ft  
 Reserve DF Area: **900** Sq. Ft

**DESIGNER STAMP HERE**

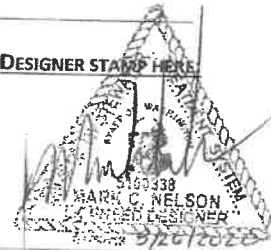

DESIGNER'S NAME: **MARK NELSON**

INSTALLER'S NAME:

EH	Version: 2	Supersedes: 1	Date Adopted: 1/1/2020	Modified By: Zac Bales	Approval By: Jesse Cox
----	------------	---------------	------------------------	------------------------	------------------------



507 N. Nanum Street, Suite 102  
 Ellensburg, WA 98926  
 T: 509.962.7515 F: 509.962.7581  
 www.co.kittitas.wa.us/health/

FOR OFFICIAL USE ONLY	
Accepted By:	SC
Permit #:	OE-10-00017
Date Processed:	5/8/20
Receipt #:	0470-00344

**RECEIVED**  
 MAY 08 2020  
 BY: SC

**APPLICATION FOR SITE EVALUATION**

**REQUESTED BY:**

Property Owners Name: Justin & Steph Zipperer  
 Site Address: 311 Big Creek Road  
 City: Cle Elum Zip: 98922  
 Telephone: ~~509-1321-1122~~ Cell: ~~509-6336-5111~~ 509-201-0041  
 Requested By: Zipperer's  
 Mailing Address: Po Box 971  
 City: Cle Elum Zip: 98922  
 Designers Name: Mark Nelson Cell: 509-304-9062  
 Signature of owner or agent: [Signature]  
 Email Results To: JUSTIN.ZIPPERER@YAHOO.COM

*Devon  
Caste*

**SITE (PARCEL MAP MUST BE ATTACHED)**

Map Parcel Number 15748 Lot #: 1  
 Subdivision: Far 160th SP Gate Code: N/A Acreage Size: 29.56 acres  
 Directions to site: Nelson Siding Road to Big Creek Rd  
lot on left

Call or Go Online to <https://www.co.kittitas.wa.us/health/> to Schedule your Inspection

**STRUCTURE (CHECK ALL THAT APPLY):**

Proposed OR  Existing  Repair OR  Alteration  
 Single Family Residence OR  Commercial Application  
 Number of bedrooms: 3 Number of permanent occupants: 4  
 Other (Specify) \_\_\_\_\_ Expected Daily Design Flow \_\_\_\_\_

*Test holes are dug -  
Please call to schedule -*

**WATER SUPPLY:**

Public Water System (3+ connections) - Name of system: \_\_\_\_\_  
 Private well  Shared well (2 connections)  
 Cistern  Well is drilled and located on attached Map  Well not drilled

**\$675.00 Site Evaluation fee is non-refundable after service has been provided.**

**Site Evaluation is valid for five years.**



507 N. Nanum Street, Suite 102  
 Ellensburg, WA 98926  
 T: 509.962.7515 F: 509.962.7581  
 www.co.kittitas.wa.us/health/

**OSS SITE EVALUATION - TEST HOLE DATA & PARCEL INFORMATION**

File Last Name: Zippereb

Parcel Number: 20-14-28059-0001

SOIL LOG # 1 PRIMARY			
Depth Feet	Texture	Structure	Color
1-	S.C.L	Granular mod w/ cobbles (Rocks)	mod ↓
2-			
3-	Root line	strong	
4-			
5-			
6-			

SOIL LOG # 2 RESERVE			
Depth Feet	Texture	Structure	Color
1-	S.C.U	Granular mod w/ cobbles Rocks	mod ↓
2-			
3-	S.C	Gravel	strong
4-	Root line		
5-			
6-			

Soil Profile		Field Observations:
C = Clay	CO = Cobbles	TH1 = .2 TH2 = .4
S = Sand	BKR = Broken Rock	
Si = Silt	HP = Hard Pan	
L = Loam	H2O = Water	
GR = Gravel	MOT = Mottling	
RL = Root Line		

Minimum Setbacks:	APP Rate:	Parcel Map/Soil log Location
<input type="checkbox"/> Surface Water (100') <input type="checkbox"/> Wells (100') <input type="checkbox"/> Water Lines (10') <input type="checkbox"/> Cut banks (25' + 5' or 50' + 5') <input type="checkbox"/> Interceptor Ditches (10' up or 30') <input type="checkbox"/> Property Lines (5') <input type="checkbox"/> Buildings (10') <input type="checkbox"/> Cuts or fills? Slope: _____ (Percent & Direction)	<input checked="" type="checkbox"/> .2 <input checked="" type="checkbox"/> .4 <input type="checkbox"/> .6 <input type="checkbox"/> .8 <input type="checkbox"/> 1.0 <input type="checkbox"/> Unsuitable <input type="checkbox"/> Restrictive Layer Depth: _____ Additional Soil Comments: _____	

Comments or Waivers: \_\_\_\_\_

Staff Signature: Janet Garcia

Date: 6/25/20



KITTITAS COUNTY  
PUBLIC HEALTH

Receipt Number: PH20-00344

507 N Nanum St., Suite 102  
Ellensburg, WA 98926  
509-962-7515 / <https://www.co.kittitas.wa.us/health/>

Payer/Payee: ZIPPERER, STEPHANIE N & JUSTIN C  
PO BOX 971  
CLE ELUM WA 98922-0971

Cashier: SAMANTHA COX  
Payment Type: CHECK (8472)

Date: 05/08/2020

OE-20-00077 On Site Sewage Evaluation		BIG CREEK RD CLE ELUM		
<u>Fee Description</u>	<u>Fee Amount</u>	<u>Amount Paid</u>	<u>Fee Balance</u>	
OSS Site Eval Permit	\$675.00	\$675.00	\$0.00	
<b>OE-20-00077 TOTALS:</b>	<b>\$675.00</b>	<b>\$675.00</b>	<b>\$0.00</b>	
<b>TOTAL PAID:</b>		<b>\$675.00</b>		

# DRAINFIELD CALCS

PROPERTY OWNER:  
PARCEL#:

ZIPPERER  
15148

NUMBER OF BEDROOMS: 3  
GALLONS/BEDROOM/DAY: 120  
ESTIMATED PEAK FLOW: 360  
SOIL APPLICATION RATE: 0.4

SQUARE FEET OF DRAINFIELD REQUIRED: 900  
GRAVELESS CHAMBER REDUCTION FACTOR: 0.6  
REQUIRED L.F. OF CHAMBERS REQUIRED: 192  
SQUARE FEET AFTER REDUCTION 540  
REQUIRED VERTICAL SEPARATION: 36"  
MAX. DEPTH OF TRENCHES: 30"  
TEST HOLE DEPTH TO RESTRICTIVE LAYER: 60"

SCALE 1" = 60' 

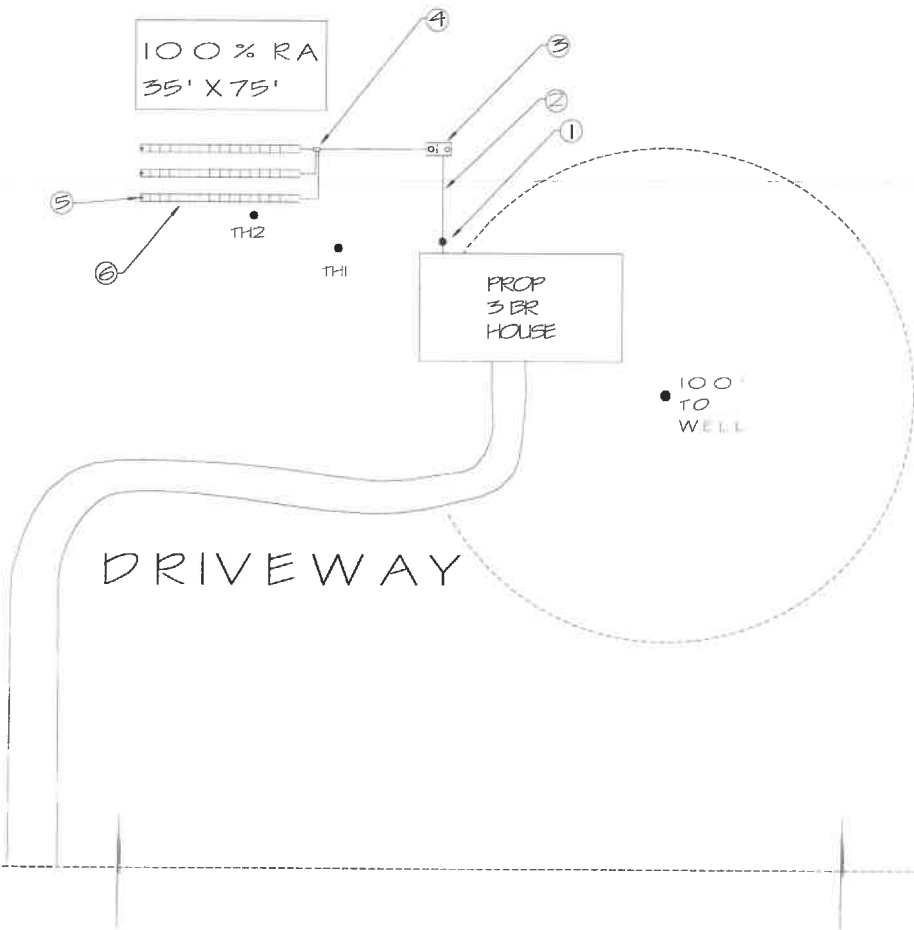

- ① 4" CLEAN-OUT
- ② 4" ASTM 3034 SEWER PIPE
- ③ 1000 GAL. 2-COMPARTMENT SEPTIC TANK
  - 5' MIN. TO HOUSE
  - 10' MIN. TO WATER LINE
  - EFFLUENT FILTER REQUIRED ON SEPTIC TANK OUTFLOW
  - ACCESSERS REQUIRED TO FINISH GRADE
- ④ P-BOX WITH PUL-A-FLOWS
  - ACCESSERS REQUIRED TO FINISH GRADE
  - 4' MIN. TO MANHOLE
- ⑤ 4" INFLECTION POINTS EXTENDED TO FINISH GRADE
- ⑥ 3" - 4" LATERAL PVD DEVICES
  - MAXIMUM 4' - 5' SPACING REQUIRED
  - 200' - 4" INFLECTION POINTS CHANNELS OR SLOTTED PVD'S
  - 4' MIN. TO PROPERTY LINE
  - 30' MIN. TO WELL
  - APPROXIMATELY 10' FROM ANY FOUNDATION

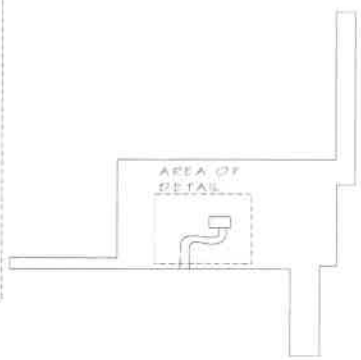

THIS PLAN IS INTENDED FOR THE APPROVAL AND CONSTRUCTION OF THE SEPTIC SYSTEM DESIGN. MCN CONSULTING RECOMMENDS THAT A LICENSED SURVEYOR (PLS) ALWAYS BE USED TO SET CORNERS, ESTABLISH LOT LINES AND DETERMINE ELEVATIONS.

OSS SITE PLAN  
DATE: 7/5/20

PROPERTY OWNER: ANDERSON  
PARCEL #: 15148

MCN CONSULTING  
MARK NELSON  
509-304-9062



## SEPTIC TANK DETAILS

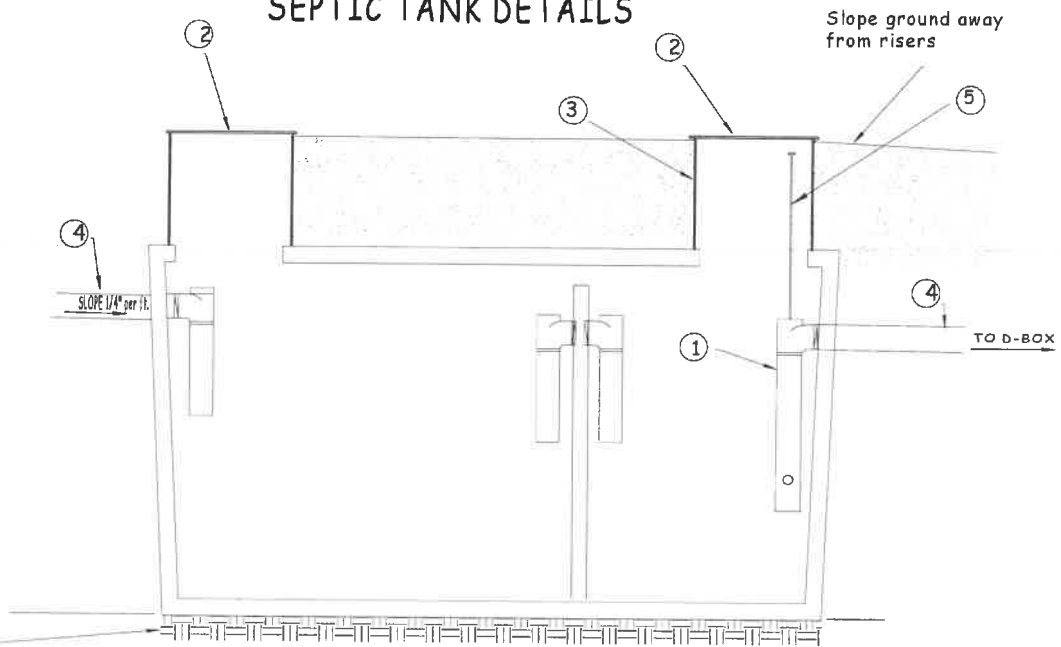

Original undisturbed soil or  
a compacted bed of aggregate

1000 G. SEPTIC TANK

- ① 4" Effluent Filter. Use Orenco Biotube model #: FTWO444-36. (or equal)
- ② 24" Fiberglass lid with self tapping stainless steel bolts.  
Use Orenco model #: OSI-FL24G-4B. (or equal)
- ③ 24" Ribbed PVC riser. Use Orenco model #: OSI-RR24. (or equal)  
adhere to riser with "Jet Set" or equivalent product. Connections must  
be water tight.
- ④ 4" SDR35 (3034) PVC.
- ⑤ Extend handle on effluent filter to within 6" of top of riser.

TANK DETAILS

NAME: ZIPPERER

PARCEL: 15148

MCN CONSULTING

MARK NELSON  
509-304-9062

### CHAMBER CROSS SECTION

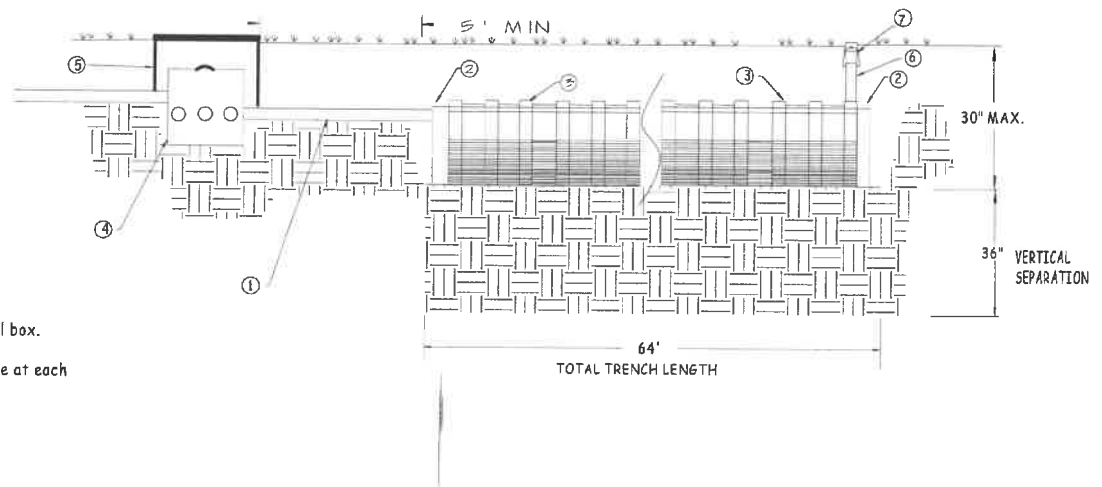
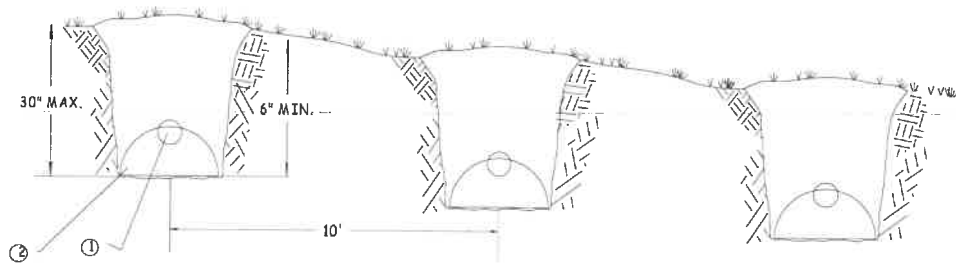

- ① 4" SDR 35
- ② Infiltrator Q4 LP end plate
- ③ Infiltrator Q4 LP chamber
- ④ Concrete D-box.  
\*5' min. from tank and drainfield.
- ⑤ Access riser  
\*Use septic tank riser or irrigation control box.
- ⑥ 4" inspection port extended to finish grade at each lateral end.
- ⑦ 4" female adapter and threaded plug.

TRENCH DETAIL	NAME: ZIPPERER PARCEL: 15148	MCN CONSULTING MARK NELSON 509-304-9062
---------------	---------------------------------	---

**Tight line from house to septic tank:**

- 1 Grade shall be 1/8" per foot minimum with the last 10 foot section having no more than 1/4" per foot.
- 2 At least one cleanout is required in this line outside the structure and within 2 feet of the structure. If the cleanout must be installed greater than 2 feet from the structure, use a 2 way cleanout. If the line extends for more than 50 feet, additional cleanouts at 50 foot intervals are required.
- 3 If there are elbows, they shall be no greater than 45 degrees.
- 4 Any pipe crossing a driving area shall be cased inside 6" SCH 40 or equal grade pipe to avoid crushing by vehicular traffic.
- 5 If the pipe must cross a water line, the sewer line shall be sleeved for 10 feet in each direction. If possible, the sewer line shall cross below the water line. There shall be no joints in the pipe used for the sleeve.
- 6 This line must be 50' minimum to any well or surface water.

**Septic Tank and Pump Tank:**

- 1 All tanks must be from a supplier whose tanks are on the Washington State list of approved septic tank providers.
- 2 The tank shall be a min. of 5' from any building, 50' from any well or surface water, 5' min. from any property line or easement, and 10' min. from any water line. Community well requires a 100' setback.
- 3 Soil beneath the inlet and outlet pipes shall be compacted to avoid settling.
- 4 All pipe connections to the tank must be water tight.
- 5 The tank shall be set on undisturbed soil or a compacted bed of aggregate.
- 6 The quick disconnect union located in the pump chamber, must be within 24" of lid/final grade.
- 7 The tank shall have riser's with secured lids at finished grade on both compartments.
- 8 An outlet filter is required.

**Tight line from the pump chamber to the manifold:**

- 1 Line shall be schedule 40 PVC
- 2 If this line crosses any water lines, it shall be sleeved for 10' in each direction. If possible, the transport line shall cross under the water line. There shall be no unglued joints in the pipe used for the sleeve.

**Manifold and flow control valves:**

- 1 Manifold and flow control valves shall be a min. of 5' to the first drainfield trench.
- 2 Valves shall be PVC ball valves.
- 3 Valves shall be in an accessible valve box at finished grade. Use a septic tank riser or an irrigation valve box with a securable lid.

**Drainfield:**

- 1 The drainfield shall be installed in the location as designed. If site conditions have changed or the system can not be installed as designed, call your designer.
- 2 The drainfield shall be installed no deeper than as specified in the design. The maximum depth is measured from the up hill side.
- 3 The drainfield must be installed in undisturbed soil.
- 4 The bottom of the trench must be level.
- 5 The drainfield shall be a min. of 100' to any well, 10' min. to any building and 5' min. to any property line or easement.
- 6 3/4"-1 1/2" washed gravel or approved gravelless chambers and Sch 40 PVC pipe shall be used.
- 7 Do not attempt to install the drainfield if the conditions are too wet. Smearing of the soil could occur, reducing its ability to absorb water. Call your designer if you are not sure if the conditions are suitable for construction.
- 8 If pressure system and drainfield is located below pumpchamber, a anti-siphon hole shall be drilled before transport pipe leaves tank.
- 9 If in an area with burrowing rodents, place chicken wire under gravelless chambers.

**General:**

- 1 System shall only be installed by a licensed contractor certified by the local health jurisdiction to install septic systems.
- 2 System must be inspected by the local health department prior to backfill and final approval.
- 3 All conduit and electrical components must be installed by a state licensed electrical contractor and approved by the Washington State Department of Labor and Industries, public health Department approval.
- 4 Bedding of pipes: 4" minimum of bedding material is to be placed under pipe and 6" of bedding material is to be placed over pipe. Native material may be used if free from rocks.
- 5 Any specified component in this design may be substituted with equal products.
- 6 If any portion of this design conflict with another, the more stringent of the two specifications shall apply.
- 7 Call your designer if you have questions or concerns.

# 4" Biotube<sup>®</sup> Effluent Filters

Submittal  
Data Sheet



Oreco Systems<sup>®</sup>  
Incorporated  
1-800-348-9843

## Applications

4" Biotube Effluent filters are designed to remove solids from effluent leaving residential septic tanks.

## General

Oreco 4" Biotube Effluent Filters (U.S. Patents No. 4439323 and 5492635) are used to improve the quality of effluent exiting a septic tank in a residential septic system. The Biotube cartridge fits tightly in the vault and is removable for maintenance; the tee handle can be extended for easy removal of the cartridge.

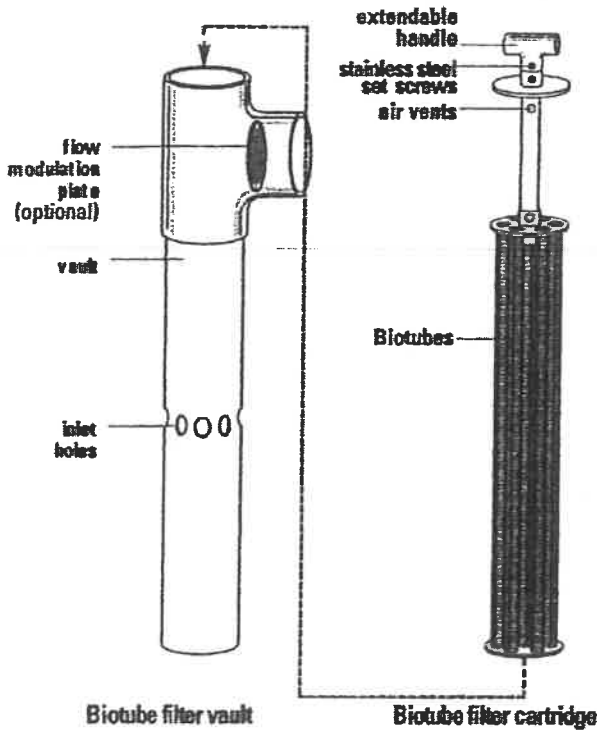

## Standard Series

FTS0444-36, FTS0444-36M, FTW0436-28, FTW0436-28M  
FTW0444-36, FTW0444-36M

## Nomenclature:

FTPW04□□-□□MA-□

For customized options (e.g., NC indicates meets North Carolina regs.)  
Indicates float bracket attached  
Indicates flow modulation plate installed  
Cartridge height. 28" and 36" are standard  
Housing height. 36" and 44" are standard  
Indicates filter diameter (in)  
W-Indicates fits 3034 outlet pipe  
S-Indicates Schedule 40 outlet pipe  
P-Indicates 1/16" filtration No P indicates 1/8" filtration  
Biotube effluent filter series

## Specifications

Component	Material(s) of Construction
Vault:	4" PVC
Biotube Cartridge:	Polypropylene and polyethylene
Handle Components:	Sch. 40 PVC, polyethylene, stainless steel
Mesh Openings:	Nominal 1/8" or 1/16"; nominal open area of 30%

# THE QUICK4® PLUS STANDARD LP CHAMBER

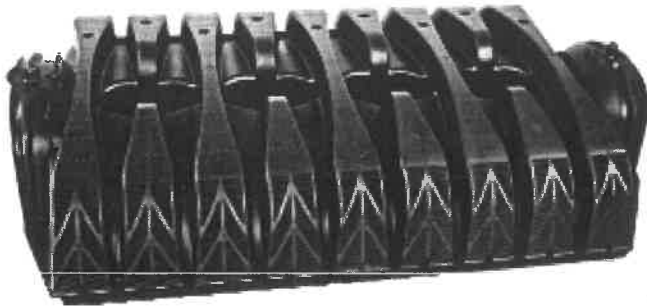

Quick4 Plus Standard LP Chamber



Quick4 Plus All-in-One Periscope



Quick4 Plus Endcap



Quick4 Plus All-in-One Endcap



Center Structural Column

The Quick4 Plus Standard Low Profile (LP) Chamber offers maximum strength through its four center structural columns. This chamber can be installed in a 36-inch-wide trench. It is shorter in height than Infiltrator's other Standard model chambers, allowing for shallower installation. Like the original line of Quick4 chambers, it offers advanced contouring capability with its Contour Swivel Connection™, which permits 10-degree turns, right and left. It is also available in four-foot lengths to provide optimal installation flexibility. The Quick4 Plus All-in-One and Quick4 Plus Endcaps are available with this chamber and provide increased flexibility in system design and configurations.

## Quick4 Plus Standard LP Chamber

- Low profile design makes this chamber ideal for shallow applications
- Reduces imported fill needed for cap and fill systems
- Center structural columns offer superior strength
- Advanced contouring connections
- Latching mechanism allows for quick installation
- Four-foot chamber lengths are easy to handle and install

## Quick4 Plus All-in-One Endcap

- May be used at either end of a chamber row for an inlet/outlet or can be installed mid-trench
- Mid-trench connection feature allows center feed inletting of chamber rows
- Center feed connection allows for easy installation of serial distribution systems
- Variable pipe connection options allow for side, end or top inletting
- Piping drill points are set for gravity or pressure pipe

## Quick4 Plus Endcap

- Simple, flat design
- Allows installation of a pipe from the end only
- Piping drill points are set for gravity or pressure pipe

**Quick4** PLUS  
STANDARD LOW PROFILE CHAMBER



# THE QUICK4 PLUS STANDARD LP CHAMBER

## Quick4 Plus Standard LP Chamber Side and End Views

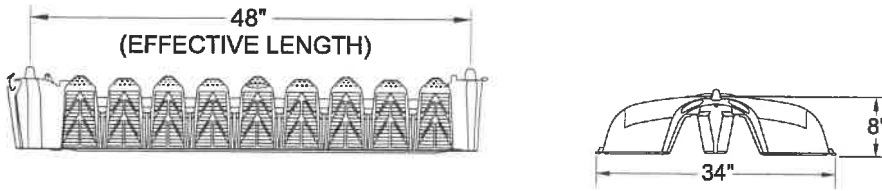

## Quick4 Plus All-in-One End Cap Front, Side and End Views

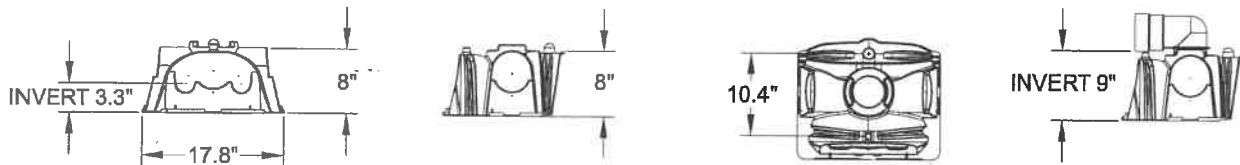

## Quick4 Plus End Cap Front, Side and End Views

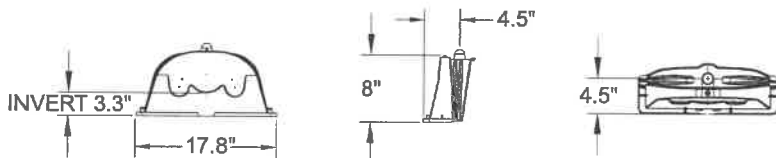

## Quick4 Plus All-in-One Periscope

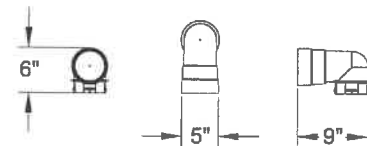

## Quick4 Plus Standard Chamber Specifications

Size (W x L x H) .....	34" x 53" x 8" (86 cm x 135 cm x 20 cm)	Invert Height .....	3.3", 9" (8.4 cm, 22.8 cm)
Effective Length .....	48" (122 cm)		

### INFILTRATOR SYSTEMS, INC. STANDARD LIMITED WARRANTY

(a) The structural integrity of each chamber, end cap and other accessory manufactured by Infiltrator ("Units") when installed and operated in a leachfield of an onsite septic system in accordance with Infiltrator's instructions, is warranted to the original purchaser ("Holder") against defective materials and workmanship for one year from the date that the septic permit is issued for the septic system containing the Units, provided, however, that if a septic permit is not required by applicable law, the warranty period will begin upon the date that installation of the septic system commences. To exercise its warranty rights, Holder must notify Infiltrator in writing at its Corporate Headquarters in Old Saybrook, Connecticut within fifteen (15) days of the alleged defect. Infiltrator will supply replacement Units for Units determined by Infiltrator to be covered by this Limited Warranty. Infiltrator's liability specifically excludes the cost of removal and/or installation of the Units.

(b) THE LIMITED WARRANTY AND REMEDIES IN SUBPARAGRAPH (a) ARE EXCLUSIVE. THERE ARE NO OTHER WARRANTIES WITH RESPECT TO THE UNITS, INCLUDING NO IMPLIED WARRANTIES OF MERCHANTABILITY OR FITNESS FOR A PARTICULAR PURPOSE.

(c) This Limited Warranty shall be void if any part of the chamber system is manufactured by anyone other than Infiltrator. The Limited Warranty does not extend to incidental, consequential, special or indirect damages. Infiltrator shall not be liable for penalties or liquidated damages, including loss of production and profits, labor and materials, overhead costs, or other losses or expenses incurred by the Holder or any third party. Specifically excluded from Limited Warranty coverage are damage to the Units due to ordinary wear and tear, alteration, accident, misuse, abuse or neglect of the Units; the Units being subjected to vehicle traffic or other conditions which are not permitted by the installation instructions; failure to maintain the minimum ground covers set forth in the installation instructions; the placement of improper materials into the system containing the Units; failure of the Units or the septic system due to improper siting or improper sizing, excessive water usage, improper grease disposal, or improper operation; or any other event not caused by Infiltrator. This Limited Warranty shall be void if the Holder fails to comply with all of the terms set forth in this Limited Warranty. Further, in no event shall Infiltrator be responsible for any loss or damage to the Holder, the Units, or any third party resulting from installation or shipment, or from any product liability claims of Holder or any third party. For this Limited Warranty to apply, the Units must be installed in accordance with all site conditions required by state and local codes; all other applicable laws; and Infiltrator's installation instructions.

(d) No representative of Infiltrator has the authority to change or extend this Limited Warranty. No warranty applies to any party other than the original Holder.

The above represents the Standard Limited Warranty offered by Infiltrator. A limited number of states and counties have different warranty requirements. Any purchaser of Units should contact Infiltrator's Corporate Headquarters in Old Saybrook, Connecticut, prior to such purchase, to obtain a copy of the applicable warranty, and should carefully read that warranty prior to the purchase of Units.



**INFILTRATOR®**  
systems inc.

6 Business Park Road • P.O. Box 768  
Old Saybrook, CT 06475  
860.577.7000 • FAX 860.577.7001

800.221.4436

[www.infiltratorsystems.com](http://www.infiltratorsystems.com)

**For technical assistance, installation instructions or customer service, call Infiltrator Systems at 800.221.4436**

U.S. Patents: 4,759,661; 5,017,041; 5,156,488; 5,336,017; 5,401,116; 5,401,459; 5,511,903; 5,716,163; 5,588,778; 5,839,844  
Canadian Patents: 1,329,959; 2,004,564 Other patents pending.

Infiltrator, Equalizer, Quick4 and Quick4 Plus are registered trademarks of Infiltrator Systems Inc. Infiltrator is a registered trademark in France. Infiltrator Systems Inc. is a registered trademark in Mexico. Contour Swivel Connection is a trademark of Infiltrator Systems Inc. © 2009 Infiltrator Systems Inc. Printed in U.S.A.

PLUS011109AG-0